



PS

DESIGN&PROCUREMENT

Senior Living Salon & Spa Equipment



OUR STORY

PS Design & Procurement officially launched in 2016 backed with PS Salon & Spa's 15+ years of operations, functionality, ROI, and licensing knowledge specifically in the senior salon & spa space after coming to the realization that we have an extremely unique wealth of knowledge that is **immensely valuable** to developers, architects, interior designers, and operators as they develop, re-develop, renovate, and/or purchase equipment for salons & spas in all levels of senior living communities.

Both the overall design/layout and purchasing/specifying the right salon & spa equipment directly impact residents' satisfaction, safety, & comfort in addition to ROI, general functionality, and the ability to properly license the salon & spa spaces once complete and ready for operation.

By partnering with us for both salon & spa **design consultation AND equipment procurement**, hundreds of companies/organizations across the country have saved significant capital, built brand consistency & marketing appeal towards residents/families and beauty professionals, avoided costly necessary changes post-project-completion, & eliminated licensing risk/exposure.

OUR SERVICES

EQUIPMENT PROCUREMENT & GROUP PURCHASING

Single project proposals, single/low quantity orders, and group purchasing platforms available.

Access to specifications from our custom portfolio of salon & spa equipment. (Completely customized to be senior-friendly, and client-customizable in finish & features)

Industry-Best Pricing & Warranties.

Quick-ship or Completely Custom equipment available.



DESIGN CONSULTATION & SPACE PLANNING*

Simple Plan review or full floorplan design services available.

Space planning, ROI analysis, licensure compliance, Equipment Selection/ Specification, CAD layouts & MEP rough-ins/elevation integration, full submittal packets, and professional renderings.

Seamless integration with all parties: developers, architects, interior designers, and operators.

*Included at no additional cost when equipment is procured through PS.

IT'S ALL IN THE DETAILS

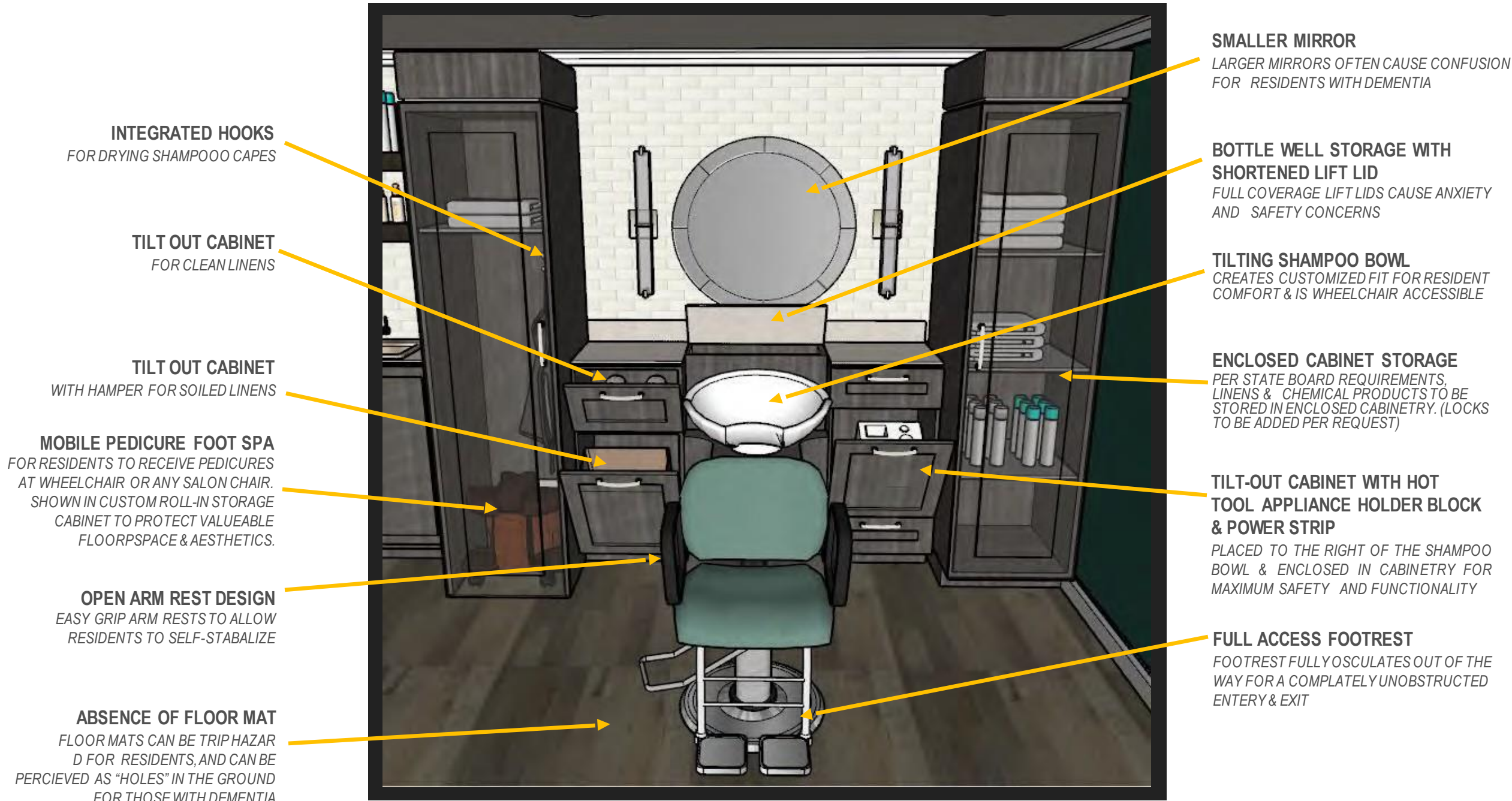

ARE YOUR SALONS?

DESIGNED WITH RESIDENTS IN MIND?

- Equipment **specifications** and **service offerings** should be based on resident level of care, safety, and comfort. Salon equipment with very specific features that have been added or modified is a must to ensure resident satisfaction and safety & reduce staff turnover.
- ROI & Productivity. Equipment **quantities** should be based on the number of residents and level of care to ensure ideal workflow and maximum amenity utilization.
- An appealing aesthetic and professional, commercial-like environment is expected.

LICENSABLE FOR OPERATION?

- Every Salon & Spa must be **licensed** properly through its State Board of Cosmetology in order to operate, and for the operator to hold proper business licensure and liability insurance coverage. (Some locations require additional licensure through the city, township, fire marshal, etc. Massage licensure is typically separate.)
- State Board of Cosmetology requirements for licensure vary **dramatically** from state to state, ranging with requirements related to minimum square footage, restroom proximity, sink types, and many other details.
- While the salon operator/vendor is typically responsible for obtaining the required licensure prior to operation, **the design and specification process needs to take these requirements into special consideration.**

A MARKETING & REVENUE DRIVER?

- The combination of an ideal layout/workflow, the right equipment, the ability to obtain proper licensure, and a focus on aesthetics will not only **appeal to residents and their adult children** to ensure your amenity is benefiting you from a marketing standpoint, but to professional salon operators/beauty professionals as well, leading to **talent retention and resident satisfaction.**

OUR PARTNERS



KEY INDUSTRY PARTNERSHIPS



PROJECT PORTFOLIO



PS DESIGN & PROCUREMENT
Location: Horizon House - Seattle, WA
In Collaboration With: Becky Ducsik - The Phinery

PROJECT PORTFOLIO



PS DESIGN & PROCUREMENT
Location: Various
In Collaboration With: Wolff & PLI

PROJECT PORTFOLIO



PS DESIGN & PROCUREMENT

Location: Various
In Collaboration With: Balfour Senior Living

PROJECT PORTFOLIO

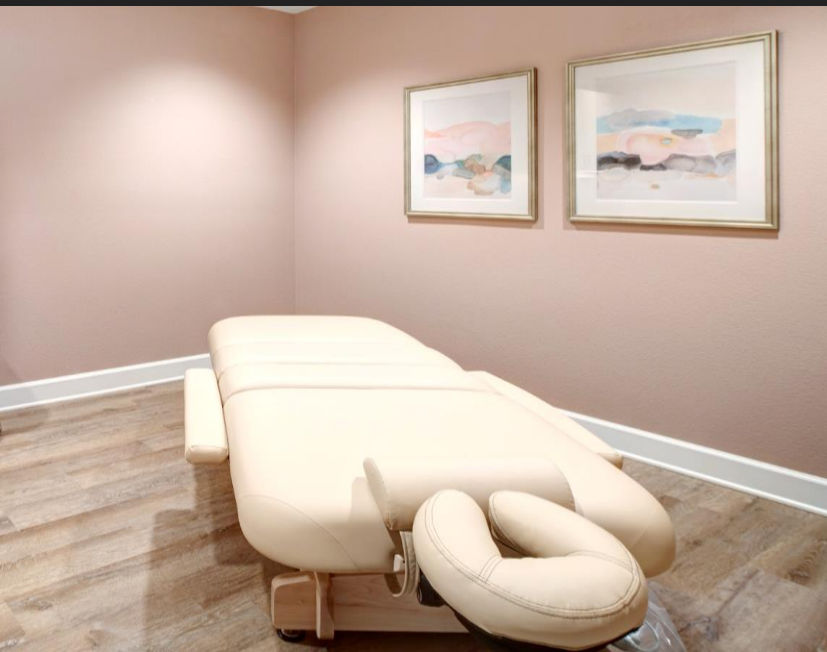

PS DESIGN & PROCUREMENT
Location: Sunrise of Cupertino
In Collaboration With: Sunrise Senior Living

PROJECT PORTFOLIO



PS DESIGN & PROCUREMENT
Location: Vicar's Landing Oak Bridge
In Collaboration With: RLPS

PROJECT PORTFOLIO

PS DESIGN & PROCUREMENT

Location: The Variel at Woodland Hills

In Collaboration With: Rodrigo Vargas Design



PROJECT PORTFOLIO



PS DESIGN & PROCUREMENT
Location: Sunrise of Orange
In Collaboration With: Sunrise Senior Living

PROJECT PORTFOLIO



PS DESIGN & PROCUREMENT
Location: Experience at Spokane
In Collaboration With: Oz Architecture



PS DESIGN & PROCUREMENT
Location: Anthology of Farmington Hills
In Collaboration With: Spellman Brady & CA Ventures



PS DESIGN & PROCUREMENT
Location: Anthology of Tanglewood
In Collaboration With: OZ Architecture & CA Ventures



PS DESIGN & PROCUREMENT
Location: Trinity Woods
In Collaboration With: PRA

SAMPLE EQUIPMENT LOOKBOOK

SCAN OR CLICK THE IMAGE BELOW TO VIEW SAMPLE EQUIPMENT FROM VARIOUS
CATEGORIES OF SALON & SPA EQUIPMENT



[CLICK ME](#)

SAMPLE PROCESS

New Development

- Client (or Project Contact) provides project information + .dwg file to PS (as soon as the amenity space location is defined within the building plans in CD or DD phase)
- PS provides recommended floor plan & equipment specifications
- Client (or Project Contact) provides approved equipment specification selections & finishes
- PS provides full product data / install packet to Client & GC
- PS procures equipment & organizes order logistics according to project schedule w/GC (ideally Client-Purchased, GC-Installed)
- GC receives & installs equipment (PS available for support throughout process)
- Residents & Beauty Professionals enjoy a safe, licensable, and beautiful salon space



SAMPLE PROCESS

Re-Development/Renovation

- Client provides project information, dimensioned as-built plan & as-built photos
- PS provides recommended floor plan & equipment specifications
- Client provides approved equipment specification selections & finishes
- PS provides space renderings (if desired; cost associated; sample below)
- PS procures equipment & organizes order logistics according to project schedule
- PS provides invoice & full product data / install packet
- Client organizes receipt & installation of equipment (PS available for support throughout process)
- Residents & Beauty Professionals enjoy a safe, licensable, and beautiful new salon space



PS DESIGN & PROCUREMENT
Location: Luther Manor
In Collaboration With: PRA

SAMPLE INSTALL PACKET

- Keyed/Coded Floorplan
- MEP & Millwork Elevations
- Product Data Sheets & Installation Instructions

SAMPLE FLOORPLAN

SALON EQUIPMENT INSTALL KEY

EQUIPMENT CODE	QUANTITY	EQUIPMENT NAME
PS1	2	53" WET STATION WITH RIGHT SET TOWER
PS2	2	53" WET STATION WITH LEFT SET TOWER
PS3	3	TILTING SHAMPOO BOWL
PS4	1	ADJUST-A-SINK
PS5	4	ALL-PURPOSE CHAIR
PS6	4	STYLIST CADDY
PS7	1	MOBILE DRYER
PS8	4	DRYER CHAIR
PS9	1	PEDICURE CHAIR
PS10	1	PEDICURE TECH STOOL
PS11	1	NAIL POLISH DISPLAY
PS12	1	MANICURE TABLE
PS13	1	MANICURE TECH STOOL

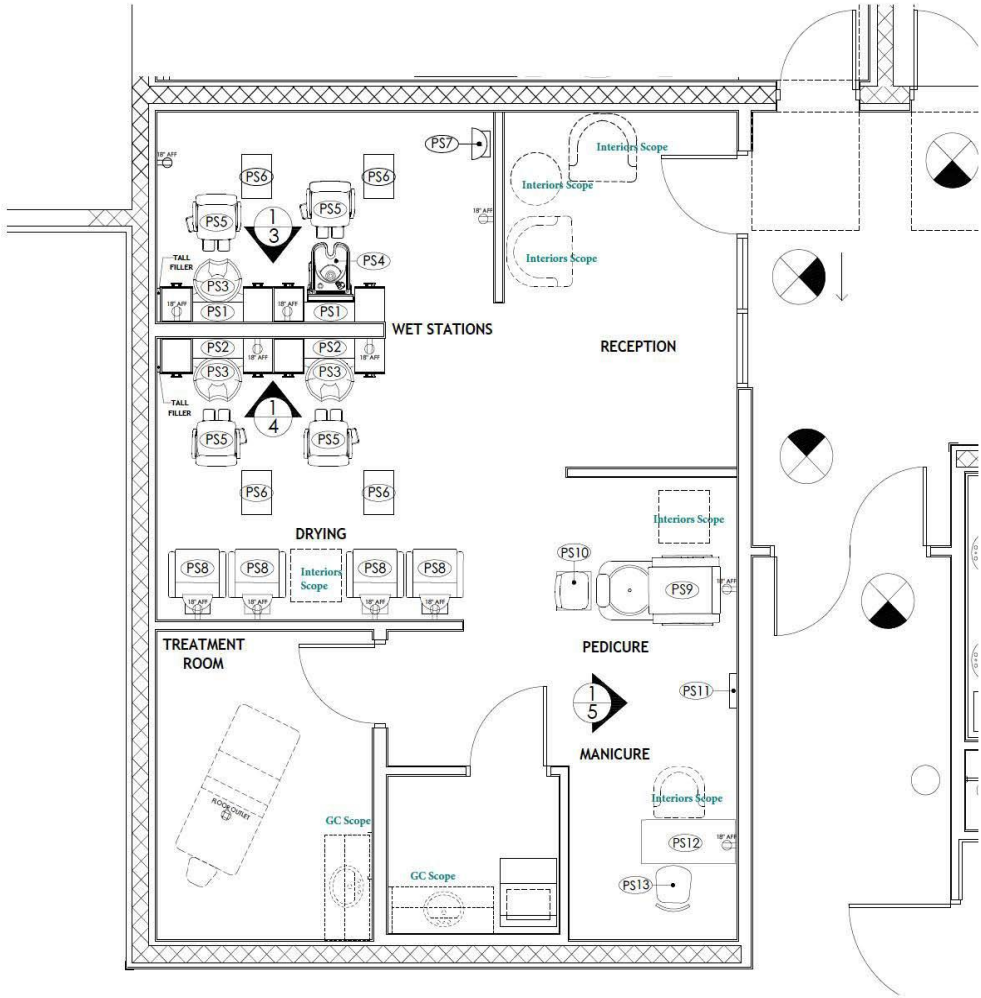

These drawings are intended as a directive only and should not be used in place of official building drawings. Additionally, the drawings will include general recommendations and rough-ins for plumbing, electrical, and ventilation, but our designers are not licensed architects or engineers and PS Design & Procurement does not assume any responsibility or liability in regards to state, federal, or local building codes. Licensed architects, contractors, plumbers, and electrician should be engaged for these specific needs.

PS

DESIGN & PROCUREMENT

PROJECT NAME HERE

SALON LAYOUT

PROJECT ADDRESS HERE

CLIENT NAME
PRO #: 2189
CARE LEVEL: IL/AL/CC
RESIDENT #: 496
SQ. FT. : 718
IMC: 2018
FLOOR LEVEL: TBD
ECD: 2020
DATE: 06-12-2020
REVISION DATE:
10-26-2020
APPROVED BY:

SCALE:

NTS

DRAWING:

1 OF 5

SAMPLE INSTALL PACKET

SAMPLE WET STATION ELEVATION FOR ROUGH-INS

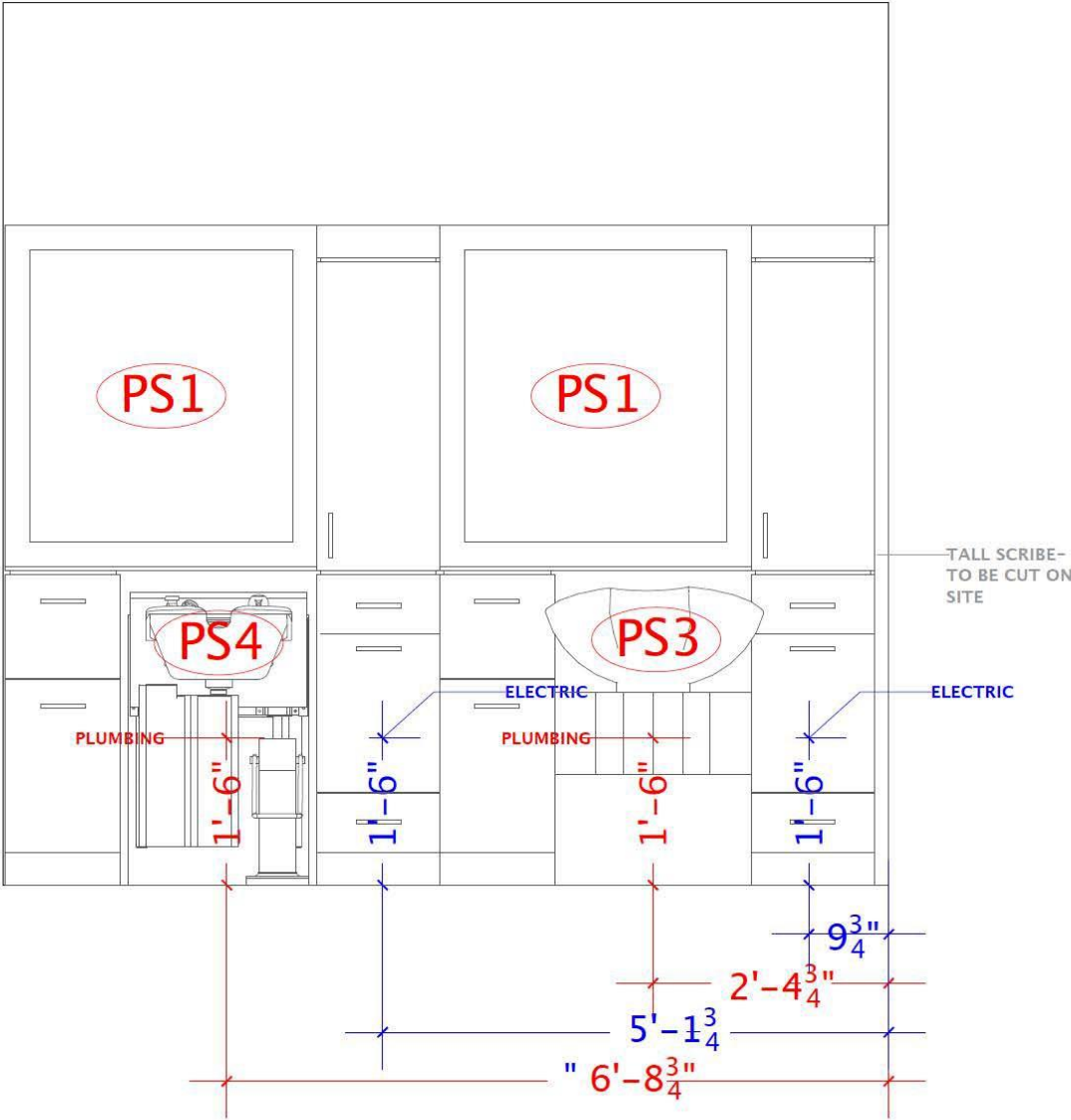

These drawings are intended as a directive only and should not be used in place of official building drawings. Additionally, the drawings will include general recommendations and rough-ins for plumbing, electrical, and ventilation, but our designers are not licensed architects or engineers and PS Design & Procurement does not assume any responsibility or liability in regards to state, federal, or local building codes. Licensed architects, contractors, plumbers, and electrician should be engaged for these specific needs.

PS
DESIGN&PROCUREMENT

PROJECT NAME HERE SALON LAYOUT	
PROJECT ADDRESS HERE	
CLIENT NAME	
PRO #: 2189	
CARE LEVEL: IL/AL/CC	
RESIDENT #: 496	
SQ. FT. : 718	
IMC: 2018	
FLOOR LEVEL: TBD	
ECD: 2020	
DATE: 06-12-2020	
REVISION DATE: 10-26-2020	
APPROVED BY:	

SCALE:
NTS

DRAWING:
3 OF 5

SAMPLE INSTALL PACKET

SAMPLE MANICURE & PEDICURE ELEVATIONS FOR ROUGH-INS

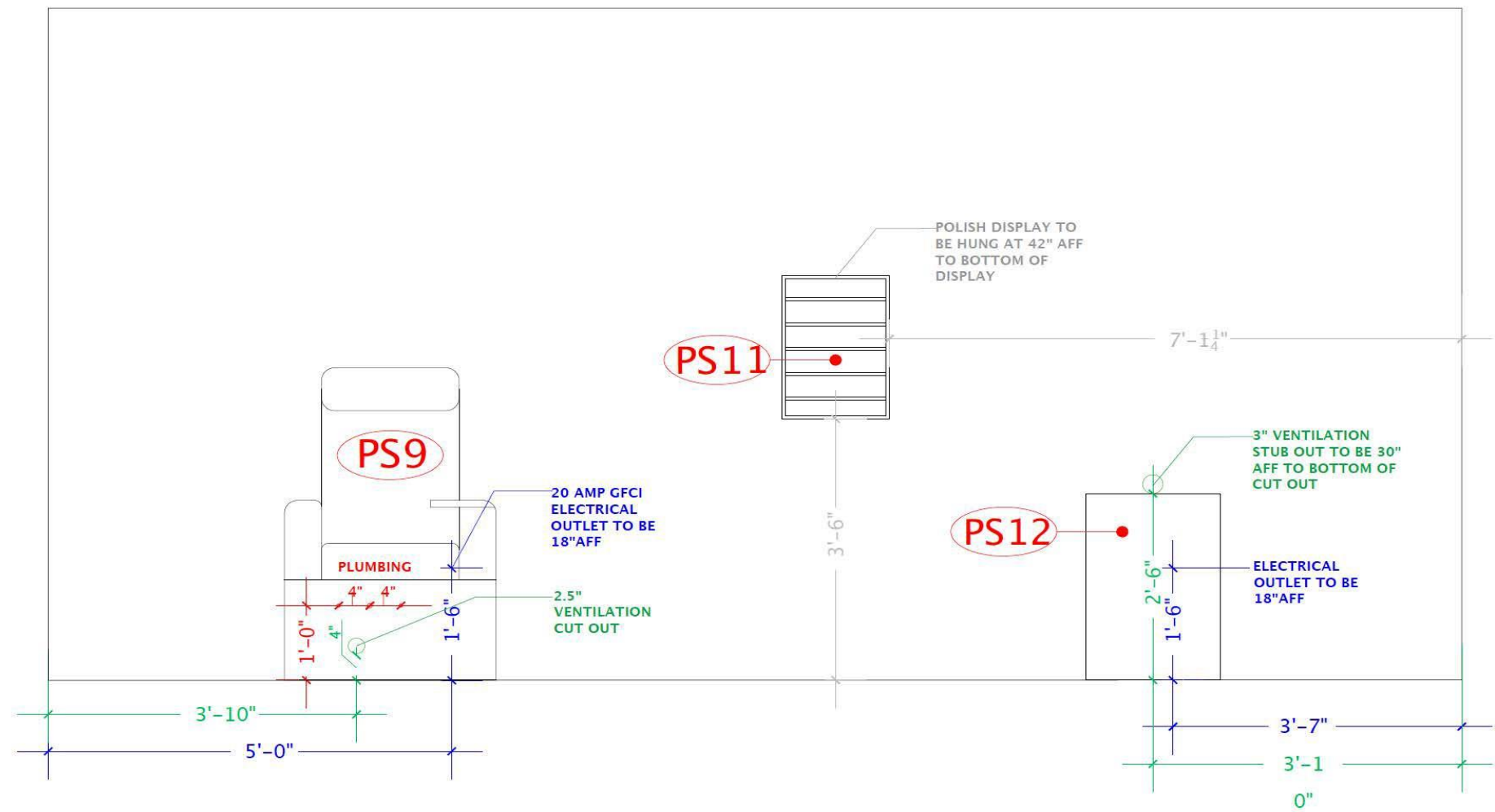

These drawings are intended as a directive only and should not be used in place of official building drawings. Additionally, the drawings will include general recommendations and rough-ins for plumbing, electrical, and ventilation, but our designers are not licensed architects or engineers and PS Design & Procurement does not assume any responsibility or liability in regards to state, federal, or local building codes. Licensed architects, contractors, plumbers, and electrician should be engaged for these specific needs.

PS

DESIGN & PROCUREMENT

PROJECT NAME HERE

SALON LAYOUT

PROJECT ADDRESS HERE

CLIENT NAME
PRO #: 2189
CARE LEVEL: IL/AL/CC
RESIDENT #: 496
SQ. FT. : 718
IMC: 2018
FLOOR LEVEL: TBD
ECD: 2020
DATE: 06-12-2020
REVISION DATE: 10-26-2020
APPROVED BY:

SCALE:
NTS

DRAWING:
4 OF 5

SAMPLE INSTALL PACKET



PS Custom Retractable Pedicure Chair w/ Ventilation Ducting & Relaxor



DESCRIPTION

This Retractable chair is the industry's most compact luxury mani/pedi chair. The chair features a retractable, motorized, fully plumbed pedicure bowl. With a retracted footprint similar to that of a standard armchair, the Retractable Compact chair is an incredible space saver, and an easy replacement for uncomfortable banquettes. Its versatility maximizes revenue through flexible scheduling for either manicures, pedicures, or express combo treatments. This luxurious, bespoke chair is hand upholstered from a broad array of fabric selections and finishes. Electronic chair, bowl and footrest adjustments enable perfect client and technician ergonomics. The hidden pedicure unit features whisper quiet, reliable pipeless hydrotherapy, and is packed with practical features including a hand sprayer, power remote drain, and convenient plumbing connects.

**The units act as a source capture unit with pass-through ventilation only with a concealed airflow and outlet duct in order to be hooked up to building ventilation.*

**All ventilation mechanics, switches, fans, etc are from the building.*

MATERIAL/FINISH

Vinyl: TBD
Laminate: TBD
Glass Color: Black or White: TBD
Powder Coat Basin Trim: Black or White TBD

WARRANTY

All items have a two year warranty, unless otherwise noted

ELECTRICAL

- 110V/220V available
- 9.5 ft long cord
- International plug options
- Chair and tub = 7.9 Max Amps
- Relaxor® = 4 Max Amps
- Discharge Pump = 1.5 Max Amps

PLUMBING

Flex Line Connections Recommended.
Must install to wall plumbing.

**See drawings for more details.*

SIZE/ DIMENSIONS

Chair Dimensions:

- Chair Height: 50.25" (128 cm)
- Seat Height: 22" (56 cm)

Footprint Dimensions:

- Tub retracted: 30.25" (77 cm)
- Tub extended: 57.5" (146 cm)
- Width: 31.5" (80 cm)
- Tilt: Allow 10" - 12" (25 cm - 31 cm) behind chair for back tilt / plumbing access

**Installation instructions to follow*

55 Public Square, Suite
2075, Cleveland, OH 44113
(216) 800.4422

***Conceptual Photo*

REFERENCES

Kristin Cornell
SUNRISE SENIOR LIVING
McLean, VA
M: 571-314-3531
kristin.cornell@sunriseseniorliving.com

Jenny Hathaway
BALFOUR SENIOR LIVING
Louisville, CO
M: 303-564-4546
jhathaway@balfourcare.com

Zach Lunden
PILLAR/ MERRILL GARDENS
Seattle, WA
T: (253) 448-3081
zachl@pillarproperties.com

Brett Montgomery
ALLIANCE RESIDENTIAL
San Diego, CA
T: 909.229.2189
bmontgomery@allresco.com

Julia Bailey
OZ ARCHITECTURE
Denver, CO
M: 847-946-2888
jbailey@ozarch.com

Tiffany Spooner
CARE PURCHASING SERVICES
Delray Beach, FL
T: 561-894-7617
spoonertiffany@carepurchasing.com

David Berrien
ERICKSON SENIOR LIVING
Baltimore, MD
M: 410-829-6577
david.berrien@erickson.com

Stacy Hollinger
RLPS INTERIORS
Lancaster, PA
T: 717.560.9501
shollinger@rlps.com

Jennifer Sodo
EUA
Milwaukee, WI
T: 414.291.8189
jennifers@eua.com

“Erickson Living has been very pleased with our ongoing successful partnership with PS Design & Procurement. Over the years, the process has been easy, and the quality of work outstanding – and most importantly, our residents continue to enjoy their salon experiences! I would not hesitate to recommend your firm to others.”

- David Berrien, Erickson Senior Living

info@psdesignandprocurement.com